

# MODEL 8882 38 TON UNIVERSAL FIXED HEIGHT TRIPOD JACK

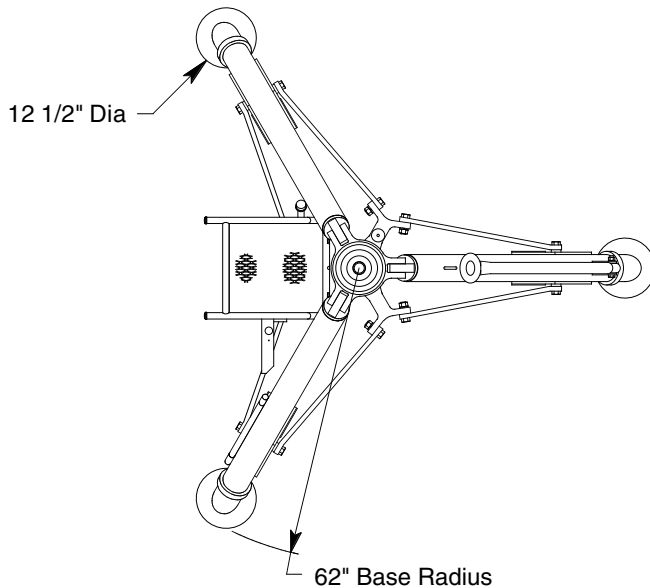

**JACK INCLUDES:**

- Manual Hand Pump with high, medium and low pressure operating positions
- Heavy Duty Tow Handle and Swivel Casters with Swivel Locks for improved towing
- Adjustable Swivel Feet with Level for leveling jack
- Hydraulic "Thermal" Relief Valve for added protection and safety in the event of internal fluid expansion due to temperature
- Secondary Cylinder Seal for protection against contaminants and to prolong life of primary seal
- Rain Hat (covers jack upper head)
- Hard Chrome Plated Cylinder Bore
- All unpainted parts are plated to resist corrosion
- Skydrol Resistant Paint (safety yellow)
- Factory Proof Load @ 150% of rated capacity
- 3 Year Warranty
- Shipping Skid

**STANDARD OPTIONS:**

- Air Operated Hydraulic Pump
- Load Gauge for load indication (reads tons/psig)
- Ladder/platform

Model 8882 is built to withstand harsh environmental conditions, rugged use and to provide many years of continuous service. Our customers are guaranteed a quality product with each purchase and are assured of our continued product support whenever and wherever the need arises.

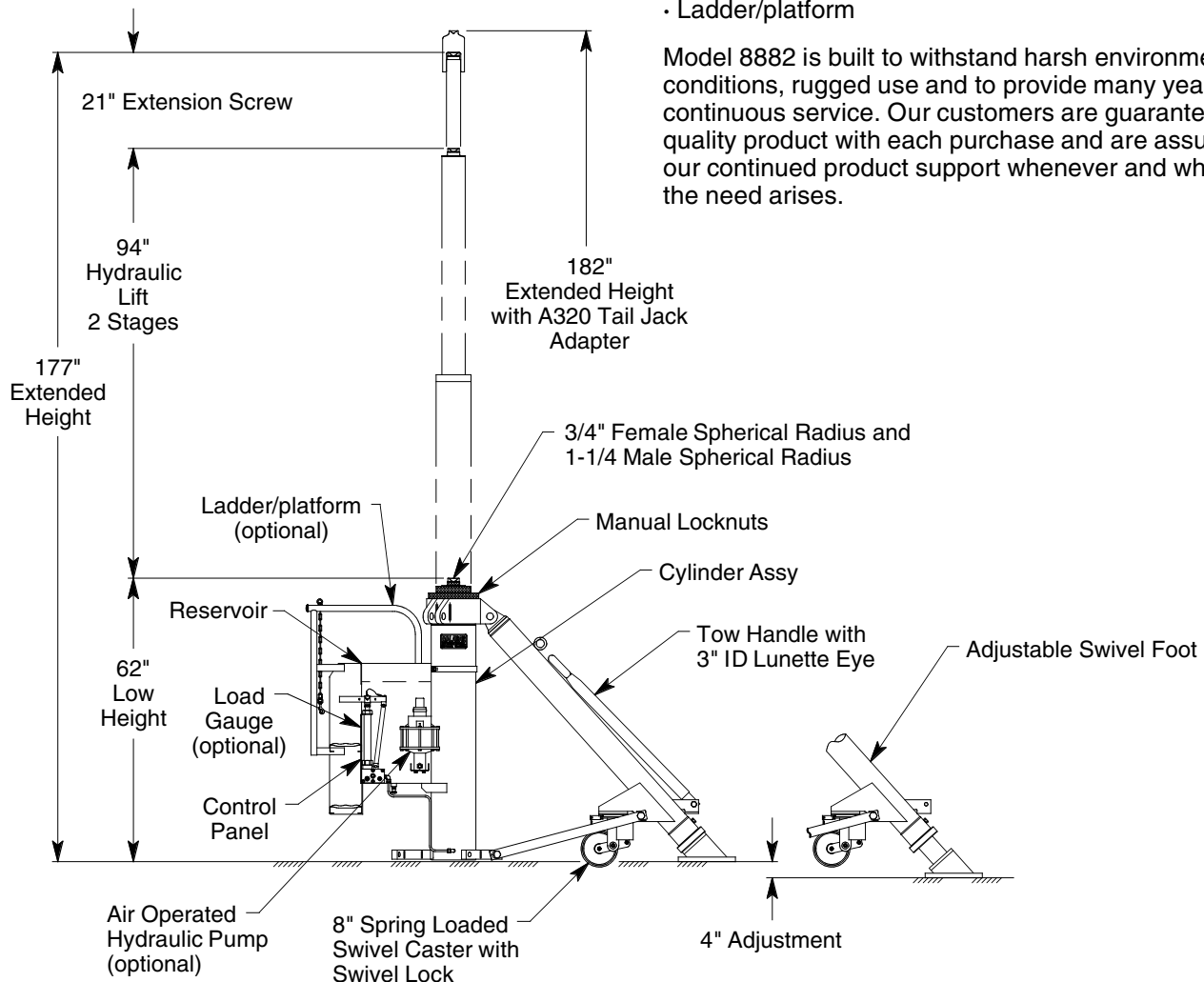

See Reverse Side for Specifications, Options, Aircraft Applications & Shipping Data

# MODEL 8882

## 38 TON UNIVERSAL FIXED HEIGHT TRIPOD JACK

### SPECIFICATIONS

Rated Capacity: 38 tons (34.5 m. tons)  
 Side Load: 15% of vertical load  
 Roll Under Height: 63.5 inches (1613 mm)  
 Low Height: 62 inches (1575 mm)  
 Hydraulic Lift: 94 inches (2388 mm)  
 Extension Screw: 21 inches (533 mm)  
 Total Extended Height: 177 inches (4496 mm)  
 Total Extended Height with A320 Tail Adapter: 182 inches (4620 mm)  
 Oil Pressure at Rated Capacity: 3065 psig (216 kg/sq cm)  
 Safety Pop-off Valves  
 System Relief Valve set at: 41.8 tons (37.9 m. tons)  
 Thermal Relief Valve set at: 47.5 tons (43.1 m. tons)  
 Proof Load: 57 tons (51.7 m. tons)  
 Reservoir Capacity: 26 gallons (98.4 liters)  
 Hydraulic Fluid: MIL-H-5606 or equivalent  
 Maximum Towing Speed: 5 mph (8 km/h)  
 Approximate Jack Net Weight: 2000 lbs (900 kg)

### MODEL 8882 TYPICAL AIRCRAFT APPLICATIONS

Nose, Wing and Tail Jack Points

A319, A320, A321, B737-100 thru -900

#### OPTIONAL EQUIPMENT CODES: (Specify at time of order)

AP: Air Operated Hydraulic Pump  
 GA: Load Gauge  
 LA: Ladder/platform  
 SPC: Special Paint Color (yellow is standard)  
 8882PK: Repair Kit

#### PACKAGING CODES & OPTIONS: (Specify at time of order)

KD: Domestic Skid - Jack Knocked Down  
 ECKD: Export Crate - Jack Knocked Down (Additional Cost)

### SHIPPING DATA

NOTE: Unless otherwise specified, Model 8882 jack is shipped on a wood skid in the knocked down condition. Refer to Malabar Tripod Jack Shipping Supplement for additional packaging information.

Packaging Code	Length inch (mm)	Width inch (mm)	Height inch (mm)	Weight lbs (kg)
KD	84 (2134)	40 (1016)	56 (1422)	2200 (998)
ECKD	86 (2184)	45 (1143)	59 (1499)	2600 (1179)